

EXTRACT FAN SCHEDULE

REF	FLOW RATE	FAN TYPE
EF1	15L/S	VENT AXIA SILENT FAN HUMIDISTAT MODEL
EF2	30L/S	KITCHEN EXTRACT HOOD SUPPLIED BY OTHERS

© COPYRIGHT EDP:
THIS DRAWING REMAINS THE PROPERTY OF EDP ENVIRONMENTAL.
NOTE: DO NOT SCALE FROM THIS DRAWING. ALL DIMENSIONS SHALL
BE CHECKED ON SITE. ONLY FIGURED DIMENSIONS SHALL BE USED.
IF IN DOUBT, ASK.
THIS DRAWING SHALL BE READ IN CONJUNCTION WITH ALL
RELEVANT DRAWINGS, DOCUMENTS AND INFORMATION PREPARED
BY THE ARCHITECT, OTHER CONSULTANTS AND SPECIALISTS.
THIS DRAWING SHALL BE READ IN CONJUNCTION WITH EDP
ENVIRONMENTAL MECHANICAL & ELECTRICAL SERVICES
SPECIFICATION & TECHNICAL SCHEDULES

HEALTH & SAFETY

HEALTH & SAFETY
STANDARD CONSTRUCTION HAZARDS THAT A COMPETENT CONTRACTOR WOULD BE AWARE OF DURING NORMAL WORKING PRACTICES ARE NOT IDENTIFIED ON THIS DRAWING. RISKS THAT MAY NOT BE IMMEDIATELY APPARENT ARE LISTED BELOW.

NOTES

1. MAKE DUE ALLOWANCE FOR PIPEWORK MOVEMENT FROM EXPANSION/CONTRACTION AND TO LIMIT ANY NOISE.
2. FIT DRAIN VALVES AT ALL LOW POINTS IN THE SYSTEM AND AAVS AT HIGH POINTS.
3. ALL SERVICES IN FLOOR VOIDS, CASINGS, DUCTS ETC AND IN PLANT ROOMS SHALL BE INSULATED IN ACCORDANCE WITH CURRENT REGULATIONS.
4. INSULATION ON PIPEWORK TO HAVE A GWP LESS THAN 5.
5. ALL HEATING PIPEWORK AND HEAT SOURCE SHALL BE INSTALLED, TESTED, FLUSHED THROUGH AND COMMISSIONED IN ACCORDANCE WITH BS 6700. HEATING SYSTEM SHALL BE THOROUGHLY FLUSHED WITH CLEAN WATER AND REFILLED USING SENTINEL X100 FLUID IN ACCORDANCE WITH SENTINAL DATA SHEETS AND HEAT SOURCE MANUFACTURERS RECOMMENDATIONS.
6. PIPES TO BE INSTALLED AT LEAST 1M AWAY FROM SMOKE DETECTORS IF THIS IS NOT POSSIBLE THEN A BLANKING PLATE NEEDS TO BE INSTALLED AS PER MANUFACTURERS INSTRUCTIONS.
7. 10mm GAPS UNDER BEDROOM/LIVINGROOM DOORS ARE REQUIRED FOR THE AIR TO FLOW FREELY AROUND THE FLAT.

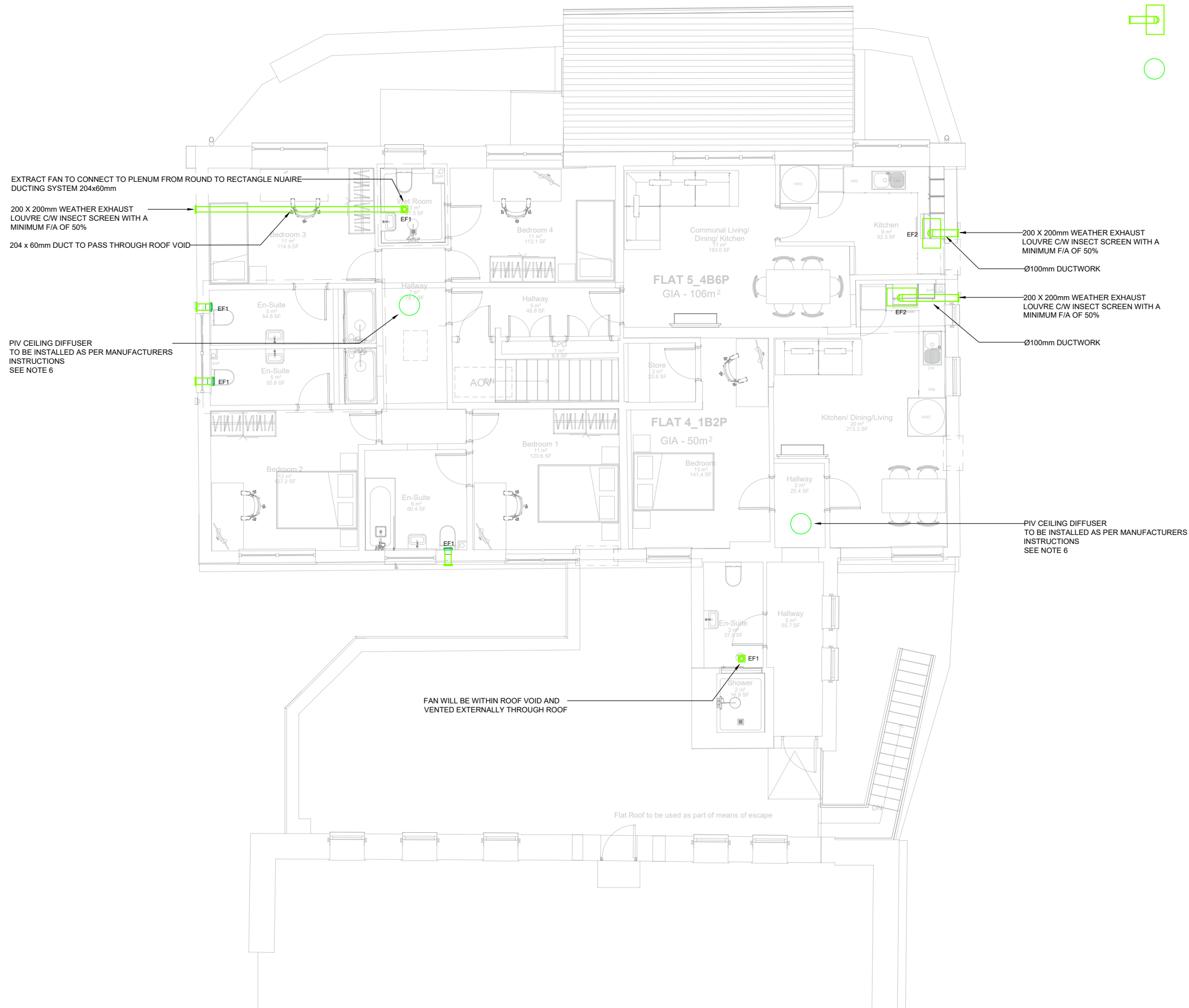

P01	31.07.25	FIRST ISSUE
REV	DATE	REVISION DESCRIPTION
SCHEDULE OF REVISIONS		

Architects Model:
Structural Model:
Other Model:
Model Schedule Key: [Discipline] _ [Date Received] _ [Revision] _ [Specific Model Number]



HEAD OFFICE
EMBLEM HOUSE
PYNES HILL
EXETER, EX2 5BA

EXETER T: 01392 367 237
BRISTOL T: 01173 258 975
FAREHAM T: 01329 800 710
LONDON T: 02076 091 899
CHOBHAM T: 01276 300 280

CLIENT:
COUNCIL OF THE ISLES OF SCILLY

PROJECT:
PARK HOUSE, ISLES OF SCILLY

DRAWING TITLE:
VENTILATION LAYOUT
FIRST FLOOR

SERVICE TYPE:
MECHANICAL

DRAWING STATUS CODE:

REVIEW AND COMMENT

SCALE @ A1 1:50	INTERNAL PROJECT REF: 2606
--------------------	-------------------------------

DRAWING NUMBER:
2606-EDP-XX-01-DR-M-2001

PROJECT NUMBER - ORIGINATOR - ZONE - LEVEL - TYPE - ROLE - SEQUENTIAL NUMBER

Designed by:	Drawn by:	Checked by:	Revision:
NO	NO	SO	P01